

Jonathan Brown.

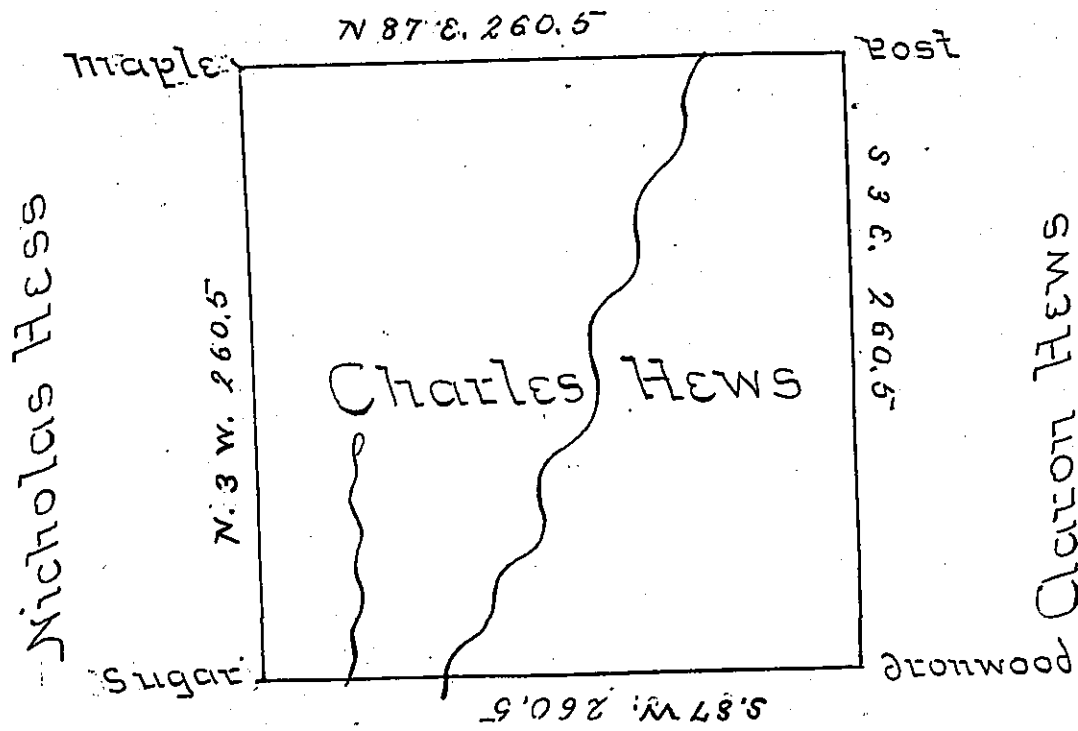

Mary Hews

Situate on the Waters of Beaver Creek in district  
 No 3 Allegheny County containing 400<sup>acs</sup> 16<sup>ps</sup> and  
 Allowance surveyed the 16<sup>th</sup> November 1795 in  
 pursuance of a Warrant granted Charles Hews  
 21<sup>st</sup> April 1794

Ben. Stokely DS

Donl. Brodhead Esq. Sg.

Now in Mercer County -

*IN TESTIMONY* that the above is a copy of the original remaining on file in  
 the Department of Internal Affairs of Pennsylvania, made  
 conformably to an Act of Assembly approved the 16th day of  
 February, 1833, I have hereunto set my Hand and caused  
 the Seal of said Department to be affixed at Harrisburg,  
 this Twenty eighth day of February 1905.

*Luca R. Brown*  
 Secretary of Internal Affairs.